

---

MEETINGS  
INCENTIVES  
**CONFERENCES**  
EVENTS

---



# WELCOME

Welcome to the Radisson Blu Hotel Athlone, with its spectacular location overlooking the River Shannon and offering magnificent views of the Marina and the historical St. Peter & Pauls Cathedral. The hotel is conveniently located in the heart of Athlone, within a 5 minute walk of the train and bus station.

# 10

MEETING ROOMS

# 700

MEETING DELEGATES  
MAXIMUM CAPACITY OF THE  
LARGEST FUNCTION ROOM

# 128

BEDROOMS INCLUDING  
16 SUPERIOR ROOMS AND  
8 SUITES

## MEETINGS & EVENTS

With over 1000m<sup>2</sup> of conference space, the Radisson Blu Hotel boasts the most impressive meetings and events facilities.

- Boasting the largest conference centre facility in Athlone
- The Marina Suite can cater for 700
- All meeting rooms are located on the ground floor and easy accessible
- Located in the heart of Ireland, only an hour and a half drive from Dublin and an hour drive from Galway
- Within walking distance from the train station, bus station and town centre
- 128 guest rooms, some with stunning views overlooking the River Shannon
- 10 modern, newly refurbished meeting rooms
- Complimentary car parking for delegates
- Quayside Bar & Lounge overlooking the River Shannon with magnificent riverside terrace
- Synergy Fitness centre with indoor pool, gym, sauna & steam room
- Nearby golf courses & stunning tourist attractions such as guided boat trips of Lough Ree
- Dedicated and experienced conference team with a "Yes I Can" attitude.

## MARINA SUITE

With over 700m<sup>2</sup> of space, the largest of our meetings and events facilities, the Marina Suite has excellent flexibility with the ability to partition into 3 separate suites making it the ideal venue for conferences, concerts, dinner dances and weddings. Each section includes in-built projector screens and LCD projectors.



Competitive rates for day meetings



Outstanding 24 hour service for events



Bespoke solutions for training, associations and charity events, healthcare meetings and packages for sports groups



Social Events



Creative packages for Christmas Parties

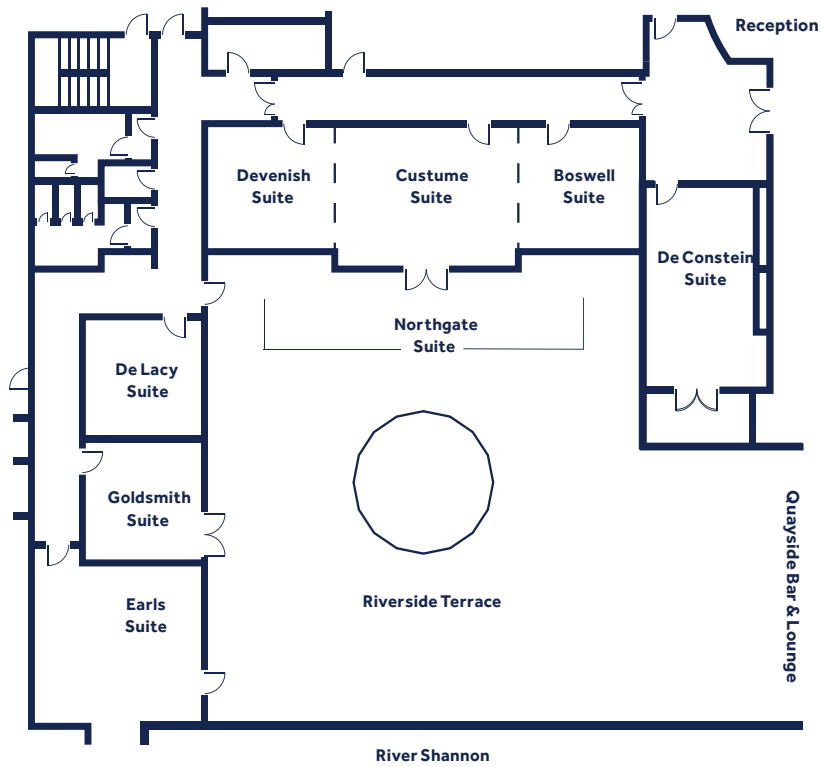
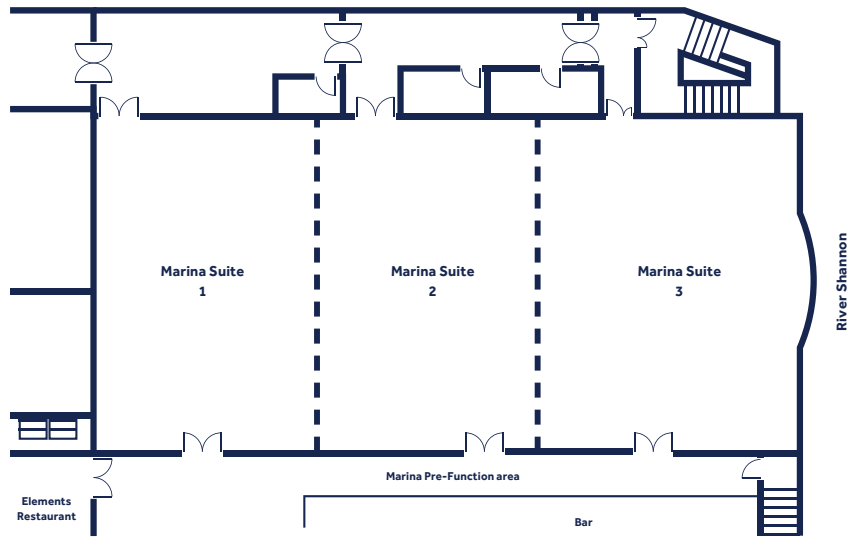

### MEETING ROOMS CAPACITY CHART

	Banquet Dinner Round	Theatre Style	U Shape	Board Room	Class Room	Caberet Style	Length & Width (m)	Ceiling Height (m)	Floor Area (m2)	Natural Daylight	Air Con.
Marina Suite 1	80	140	20	N/A	70	64	10.3x15.4	4	158.6	No	Yes
Marina Suite 2	80	140	20	N/A	70	64	10.3x15.4	4	158.6	No	Yes
Marina Suite 3	90	160	20	N/A	85	80	11.8x15.4	3	181.7	Yes	Yes
Marina Suite	380	700	N/A	N/A	320	240	32.4x15.4	N/A	498.9	N/A	N/A
Marina Suite incpre-function	420	600	N/A	N/A	N/A	N/A	32.4x22.6	N/A	677	N/A	N/A
Devenish Suite	N/A	15	10	10	8	N/A	5.2x5.1	2.82	26.5	Yes	Yes
Custume Suite	N/A	30	15	18	15	12	7.8x5.4	2.82	42.1	Yes	Yes
Boswell Suite	N/A	15	10	10	8	N/A	5.6x5.2	2.82	29.1	Yes	Yes
Northgate Suite	66	100	34	34	50	42	18.6x5.2	2.82	96.7	Yes	Yes
Goldsmith Suite	N/A	N/A	N/A	10	N/A	N/A	5.2x4.7	2.82	24.4	Yes	Yes
De Lacy Suite	N/A	N/A	N/A	10	N/A	N/A	5.1x4.7	2.82	24	Yes	Yes
De Constien Suite	N/A	30	22	20	25	28	9.3x5.3	2.82	49.3	Yes	Yes
Earls Suite	N/A	30	20	16	20	24	6.2x6.7	2.82	41.5	Yes	Yes

# PACKAGES

Based on our wide experiences of hosting various meetings and events, we can create bespoke solutions and packages to perfectly meet your specific needs. We will help to remove the stress from event planning, by creating unique package options for you to choose from.

# ROOMS & SUITES

Atmospheric lighting and specifically designed artwork inspires guests to relax, evoking the atmosphere of the great River Shannon outside. A number of rooms offer guests stunning views of the River Shannon and the old town of Athlone. Several rooms have been designed to offer total accessibility for guests with disabilities. All guest rooms include the following facilities: 24-hour room service, direct-dial telephones, satellite TV, tea & coffee hospitality tray, in room safe, iron and ironing board, free high speed WiFi and wireless LAN.

# ELEMENTS & QUAYSIDE

Relax in the atmospheric environment of our 140-seater split-level Elements Restaurant and enjoy the finest contemporary food with a mixture of Irish & European dishes. Radisson Blu's Super Buffet Breakfast offers a range of options including cold and warm buffets, the finest meats and cheeses, a selection of fruit juices, fresh fruits and water, coffees and teas with pastries and Irish breads.

Quayside Bar and Lounge has a sophisticated yet chic ambiance which provides the guest with an extremely comfortably environment in which to relax in and enjoy a drink. Bar food menu is served all day in the Quayside Bar and Lounge. It has the added feature of a large adjoining heated terrace overlooking the River Shannon, from where guests can enjoy a relaxing drink or BBQ while watching boats cruise up and down the river. Quayside Bar and Lounge is open from mid morning and is the perfect place to read the newspaper or to enjoy a light lunch from our exciting menu.

# RELAXATION

After a busy day sightseeing or attending a conference, Synergy Fitness Centre is the ideal retreat to relax and rejuvenate. Uniquely situated at water level, the fully equipped gymnasium offers views over the River Shannon. The 16.5 m indoor heated swimming pool, sauna and steam room provide the perfect place to relax and unwind.

This exclusive facility aims to provide the best in fitness knowledge and customer service, in a relaxed and friendly environment. If you have any queries, our staff are always on hand to help.







## BY CAR

From Dublin take the N4 towards Galway. Continue forward onto the N6 towards Athlone. Take exit 11 to town centre and continue towards Northgate Street.

## BY BUS OR RAIL

Athlone Bus & Rail Station is a five minute walk from the hotel. Trains run to and from Dublin & Galway daily. Bus Eireann provides daily bus services to and from all parts of the country.

## BY AIR

Dublin & Shannon airports are located approx 75 minutes drive from the hotel and offer easy access to European cities and transatlantic destinations.



Northgate Street, Athlone, Co. Westmeath, Ireland

T: +353 90 644 2600 | E: [info.athlone@radissonblu.com](mailto:info.athlone@radissonblu.com)

[radissonblu.ie/hotel-athlone](http://radissonblu.ie/hotel-athlone)